

REVISIONS				
ECN	Rev.	Description	Date (dd/mm/yy)	Approved
	K	BU11980 was 11980	28/11/07	LD
Fxxxx	L	Added BU11980 to replace BR15571 (Use To Depletion)	02/09/2011	MAN

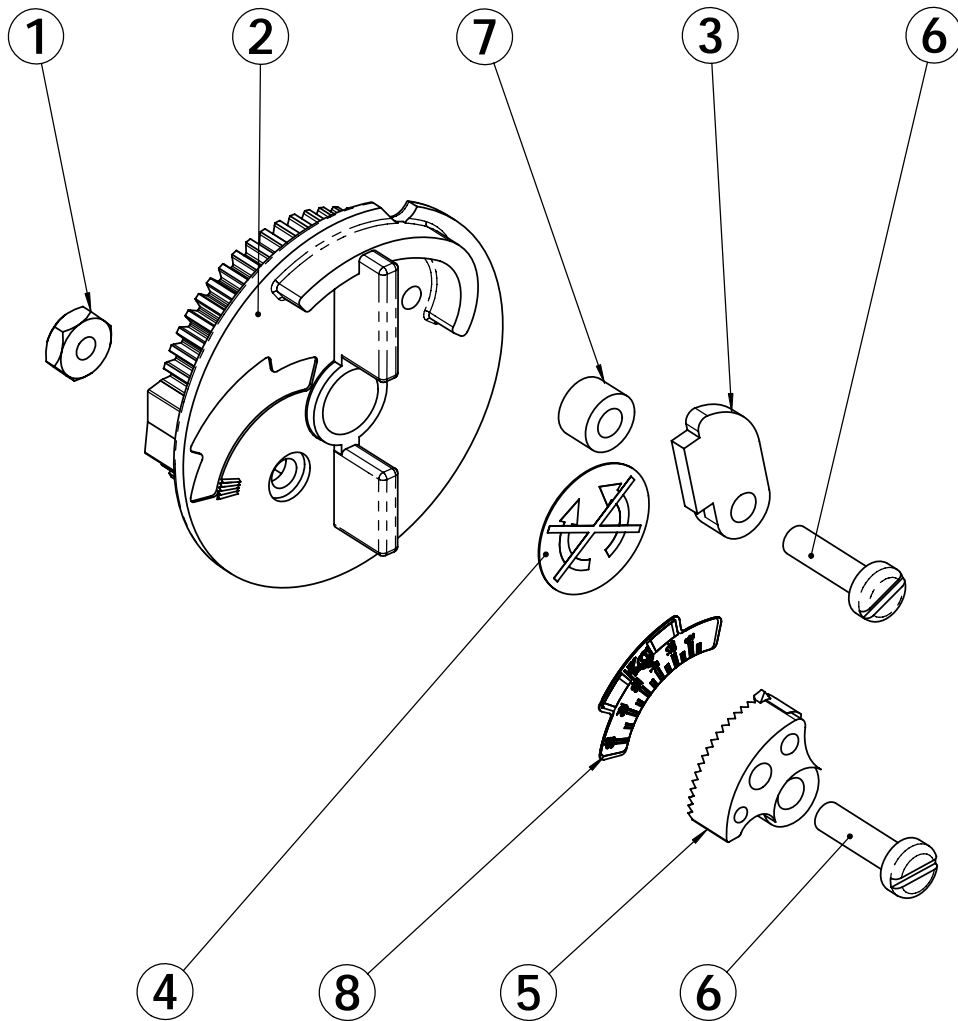

ITEM	PN	DESCRIPTION	26070-0.12 QTY	26070-0.25 QTY	26070-0.50 QTY	26070-1 QTY
1	11081	NUT	1	1	1	1
2	13168-01	BRINE CAM	1	1	1	1
3	15572	SWITCH CAM	1	1	1	1
4	26843	BRINE CAM LABEL	1	1	1	1
5	BR41123	SEGMENT,BRINE VALVE CAM	1	1	1	1
6	BU11980	SCREW	2	2	2	2
7	BU26069	SPACER	1	1	1	1
8	28231	Brine Cam Salt Label 1 - 3,5 Kg	1	-	-	-
8	28232	Brine Cam Salt Label 1,5 - 7 Kg	-	1	-	-
8	BU28233	Brine Cam Salt Label 3 - 14 Kg	-	-	1	-
8	BU28234	Brine Cam Salt Label 6 - 28 Kg	-	-	-	1



BRINE CAM DF ASSY 5600-ND MECA

26070-XX