

ITEM NO.	61832-00/QTY. BLACK / BLUE	BR61832-01/QTY. BLACK / BLACK	BR61832-02/QTY. BLACK / SILVER	PART NUMBER	DESCRIPTION
1	1	1	1	BR43261	COVER, 5800
2	1	-	-	BR43262-00	BEZEL, BLUE, 5800
2	-	1	-	BR43262-01	BEZEL, BLACK, 5800
2	-	-	1	BR43262-02	BEZEL, SILVER 5800
3	1	1	1	BR12271	BAG, POLY, 8X4X22"
4	1	1	1	BR43002	LABEL, BLANK, 3.0 X 2.0

REVISIONS					
ZONE	ECN	REV.	DESCRIPTION	DATE	APP'D
	33603	A	RELEASE FOR PRE-PRODUCTION (WAS L1463324 A.06)	07SEP2011	
	100578	B	RELEASE FOR PRODUCTION, -00 & -01	05-10-12	PWS
	100619	C	RELEASE 61832-02 FOR PRODUCTION	05-17-12	PWS

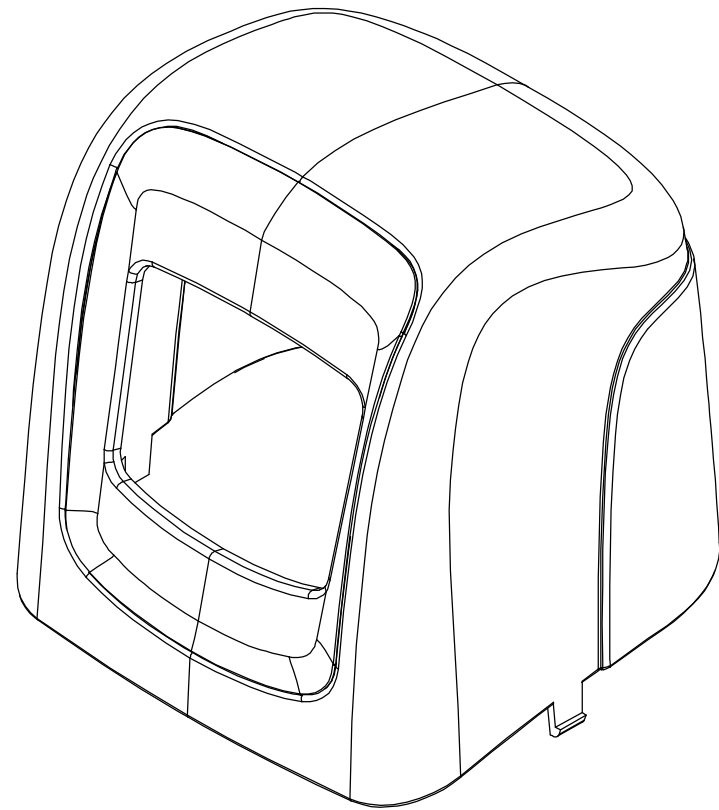

UNEXPLODED VIEW

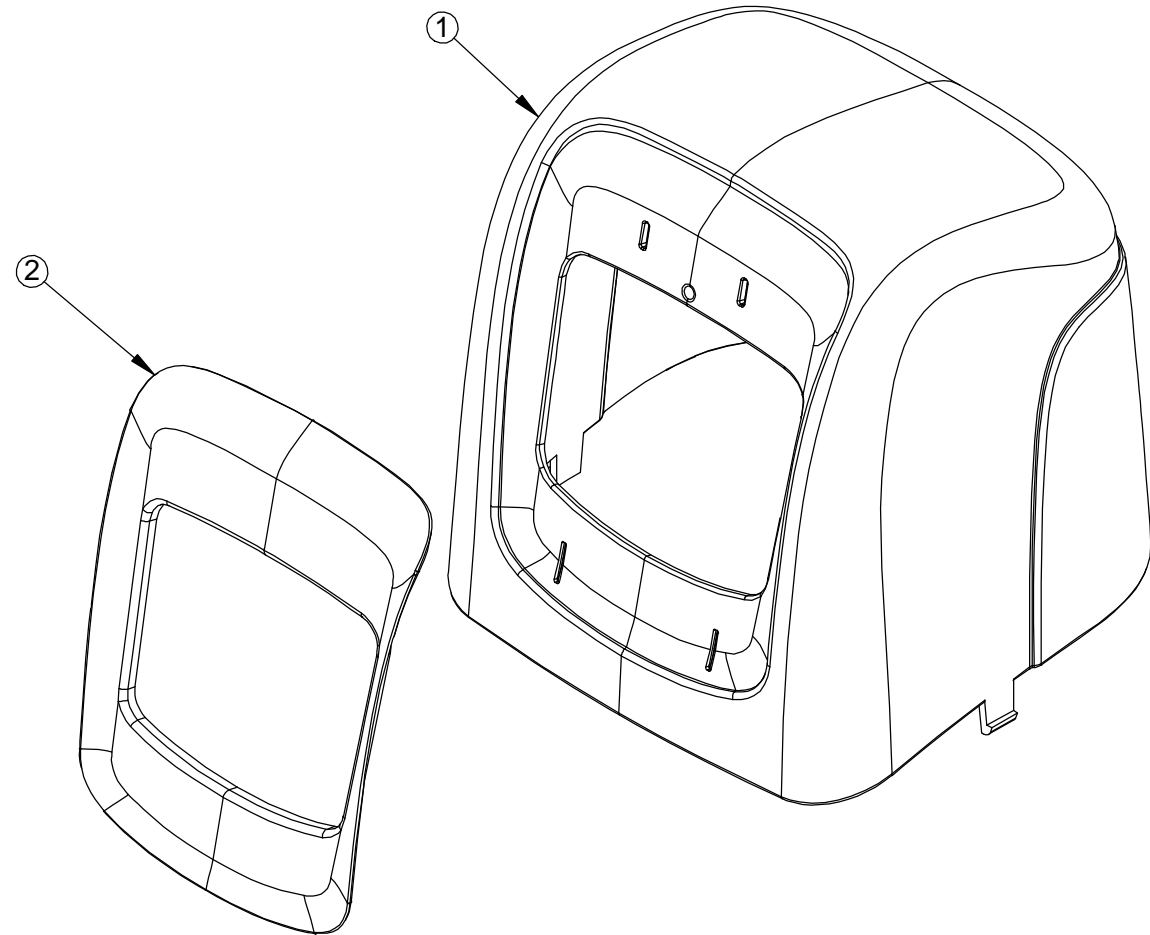

NOTES:

- ASSEMBLE BEZEL (ITEM 2) TO COVER (ITEM 1)
- PLACE ASSEMBLY IN BAG (ITEM 3)
- ATTACH SERVICE ASSEMBLY I.D. LABEL OPF0016-01.

LAST SAVED IN SMARTEAM: 6/5/2012 1:11:15 PM

CRITICALITY SYMBOLS PER QPSP-001.2
 LEVEL I LEVEL II LEVEL III

THIS DOCUMENT IS SOLELY THE PROPERTY OF PENTAIR WATER TREATMENT. REPRODUCTION, USE DISCLOSURE, OR TRANSMISSION OF THIS DOCUMENT OR DETAILS CONTAINED HEREIN, IN PART OR IN WHOLE, IS PROHIBITED WITHOUT THE WRITTEN CONSENT OF PENTAIR WATER TREATMENT ENGINEERING. THIS DOCUMENT AND ANY COPIES SHALL BE RETURNED TO PENTAIR WATER TREATMENT UPON WRITTEN REQUEST.

DO NOT SCALE DRAWING. DIMS. ARE IN INCHES [mm]
 INTERPRET DIMS AND TOLERANCES PER ASME Y14.5M -1994
 UNLESS OTHERWISE SPECIFIED:
 CORNER FILLETS R.005-.020 [.127-.508]
 TOLERANCES:
 ANGLES : ± 1°
 1 PLACE .X: ± .015 [0.38]
 2 PLACE .XX: ± .01 [0.3]
 3 PLACE .XXX: ± .005 [0.13]

THE COMPONENT, PART, OR ASSEMBLY DESCRIBED IN THIS DOCUMENT MUST COMPLY WITH THE EU (EUROPEAN UNION) DIRECTIVE: RoHS DIRECTIVE 2002/95/EC.

THIS DRAWING MUST BE COMPARED TO THE ERP SYSTEM TO ENSURE CORRECT REVISION LEVEL PRIOR TO USE.

THIRD ANGLE PROJECTION

APPROVALS	DATE	 Pentair Residential Filtration
DRAWN ZAL	8/3/11	
CHECKED		
APPROVED		TITLE COVER ASSEMBLY, 5800
		SIZE B DWG NO. BR61832 REV C
SCALE 1:2		SOLIDWORKS FORMAT SHEET 1 OF 1