

REVISIONS				
ECN	Rev.	Description	Date (dd/mm/yy)	Approved
F5030	A	CREATION	18/07/09	MAN/LD

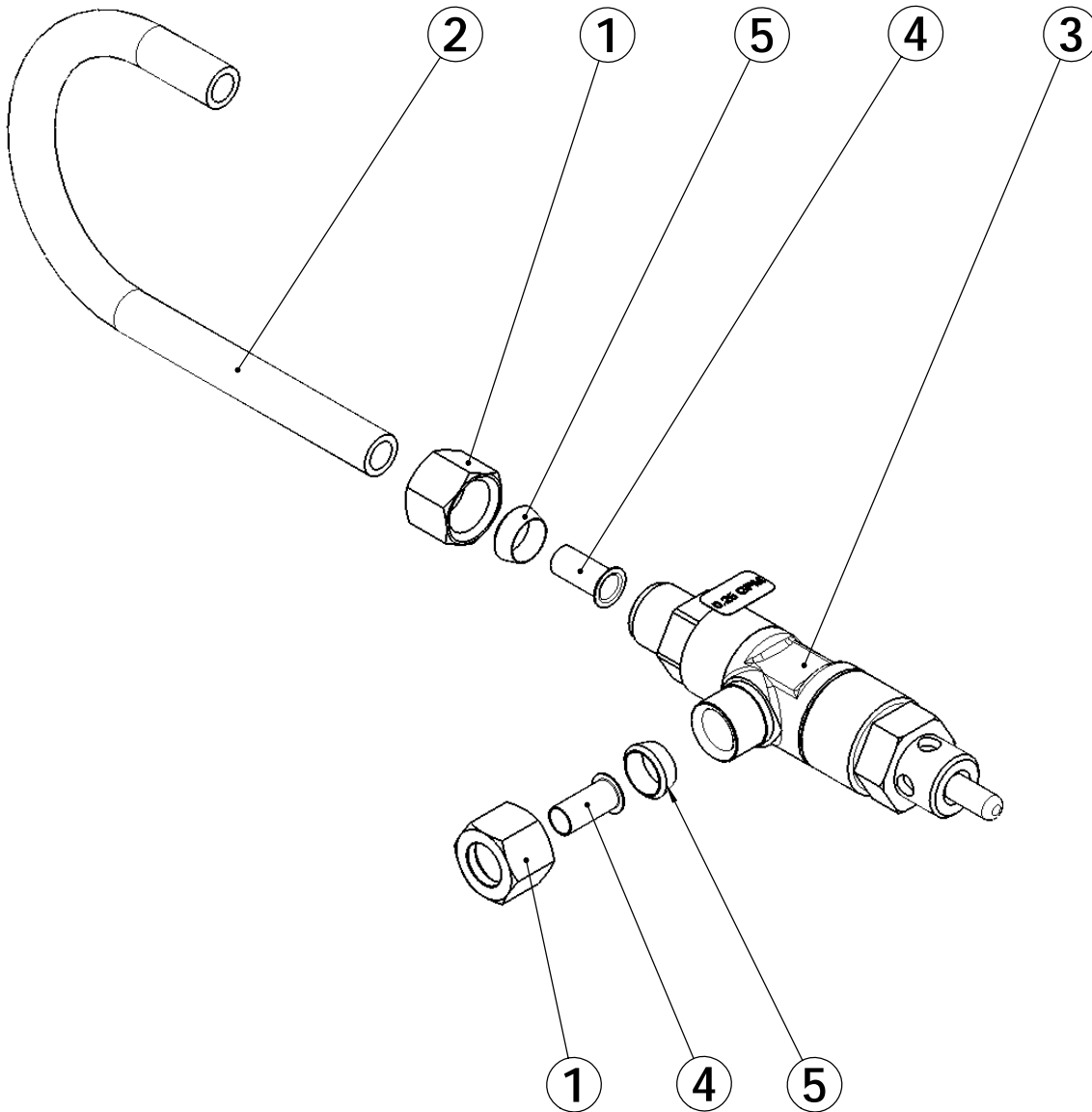

# PACKED TOGETHER

ITEM	PART NUMBER	DESCRIPTION	QTY
1	10329	3/8" NUT	2
2	16508-01	TUBE,BRINE,1600,PP BLACK	1
3	18092-xx	1600 BV AND DLFC, SPECIFY SIZE	1
4	BR10332	FITTING,INSERT,3/8	2
5	BU10330	SLEEVE (3/8" TUBE)	2



Brine Valve 1600 assy 2850 - 1 Gpm for GRUNBECK

**BU28707**