

REVISIONS				
ECN	Rev.	Description	Date (dd/mm/yy)	Approved
	A	Created on solidworks	17/11/09	LD
F5116	B	Ajout du BR19079	27/01/2010	MP
F5346	C	BR42933-10 was BU25005	12/04/2011	CHT
	D	BU28777 was BR40422	21/11/2011	CHT

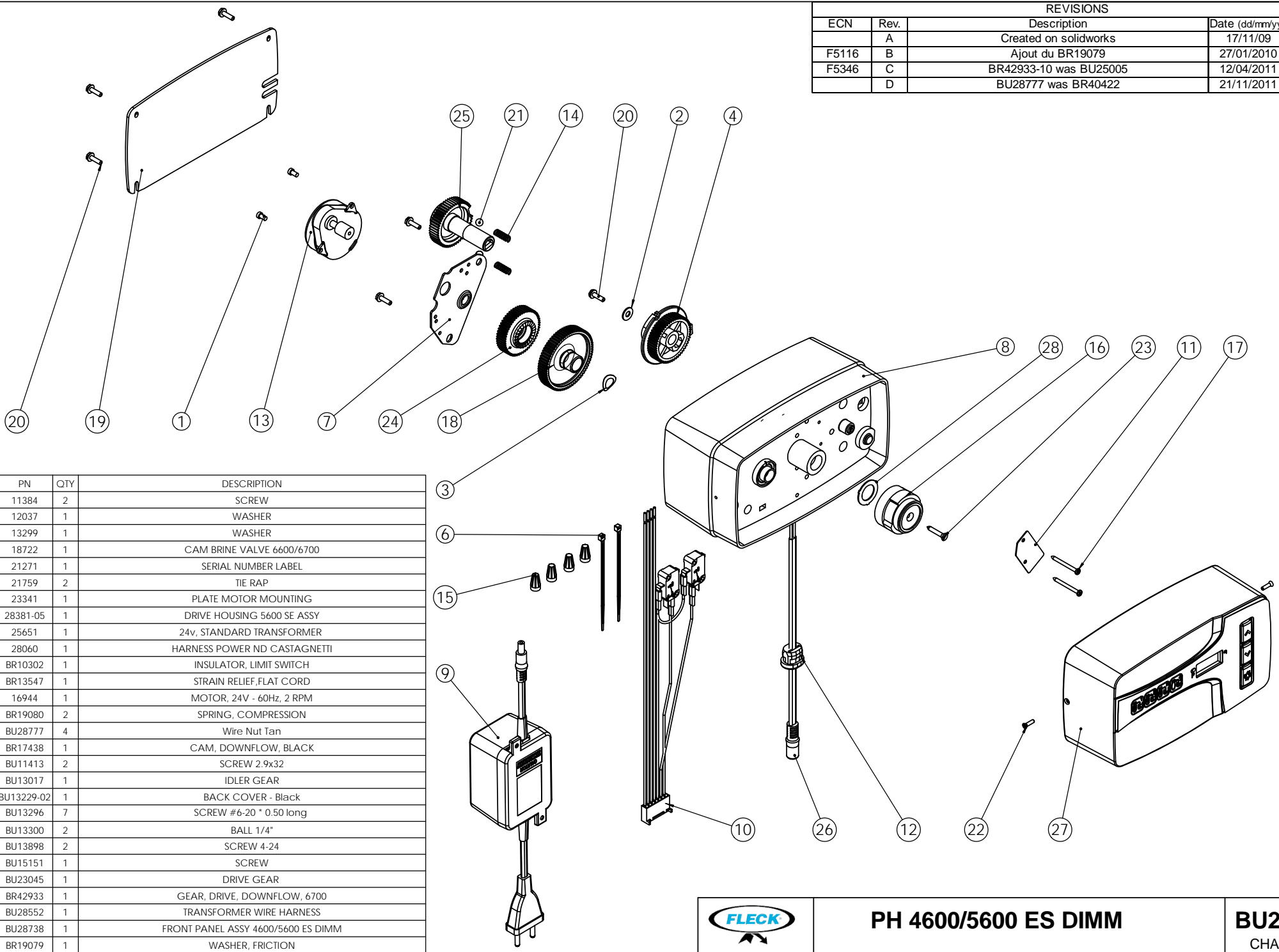

ITEM	PN	QTY	DESCRIPTION
1	11384	2	SCREW
2	12037	1	WASHER
3	13299	1	WASHER
4	18722	1	CAM BRINE VALVE 6600/6700
5	21271	1	SERIAL NUMBER LABEL
6	21759	2	TIE RAP
7	23341	1	PLATE MOTOR MOUNTING
8	28381-05	1	DRIVE HOUSING 5600 SE ASSY
9	25651	1	24v, STANDARD TRANSFORMER
10	28060	1	HARNESS POWER ND CASTAGNETTI
11	BR10302	1	INSULATOR, LIMIT SWITCH
12	BR13547	1	STRAIN RELIEF,FLAT CORD
13	16944	1	MOTOR, 24V - 60Hz, 2 RPM
14	BR19080	2	SPRING, COMPRESSION
15	BU28777	4	Wire Nut Tan
16	BR17438	1	CAM, DOWNFLOW, BLACK
17	BU11413	2	SCREW 2.9x32
18	BU13017	1	IDLER GEAR
19	BU13229-02	1	BACK COVER - Black
20	BU13296	7	SCREW #6-20 * 0.50 long
21	BU13300	2	BALL 1/4"
22	BU13898	2	SCREW 4-24
23	BU15151	1	SCREW
24	BU23045	1	DRIVE GEAR
25	BR42933	1	GEAR, DRIVE, DOWNFLOW, 6700
26	BU28552	1	TRANSFORMER WIRE HARNESS
27	BU28738	1	FRONT PANEL ASSY 4600/5600 ES DIMM
28	BR19079	1	WASHER, FRICTION



**PH 4600/5600 ES DIMM**

**BU28739**

CHAP.06